

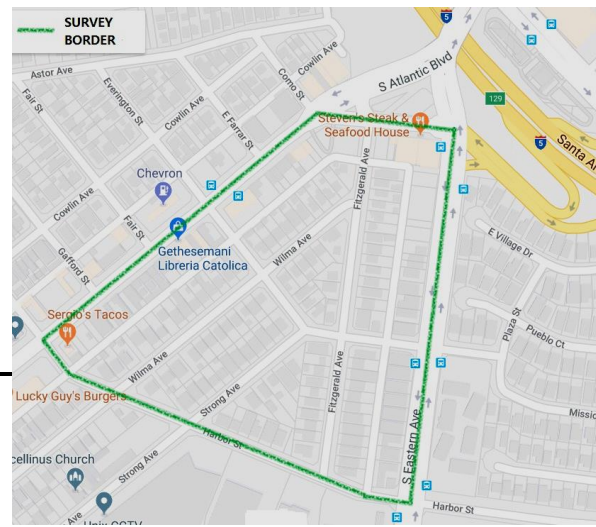

CITY OF COMMERCE

Rosini Community Survey



NAME:

ADDRESS:

PHONE:

E-MAIL:

The purpose of this community survey is to gather the opinions and sentiments of the residents who reside along and within the vicinity of Fitzgerald Avenue (in the Rosini neighborhood) along the bordering and internal streets of Stevens Place, Atlantic Boulevard, Harbor Street, Eastern Avenue, Wilma Avenue, Strong Avenue, Everington Street, and Fitzgerald Avenue. The following are some of the possible community enhancements that *could* be implemented, and the City would like for you to share your thoughts. Only ONE survey response is to be submitted per household. *Upon completion of this survey, please return it to the survey taker; otherwise, deliver this survey to Commerce Civic Center (City Hall), Community Services and Public Safety Department, 2535 Commerce Way, Commerce, CA 90040 no later than Tuesday, June 5, 2018.*

Please select any of the following suggested remedies or mitigation measures:

- ☐ Maintain “as is” (No changes to be made – Satisfied with how things are now)
- ☐ Install signs (ex., Resident Parking Only) and increase enforcement
- ☐ Install a partition (ex., fence) across Fitzgerald Avenue
(see reverse for concept rendering, i.e., picture)
- ☐ Implement permit parking program (*may* require residents to pay permit parking fees)
- ☐ Implement driveway permit parking program (permit to park in front of your residential driveway) during the busiest nights on Wednesdays and Sundays
[*may* require residents to pay permit parking fees] (see reverse for diagram)
- ☐ Other action (please specify):

CONCEPT RENDERING
PARTITION (FENCE) ACROSS FITZGERALD AVENUE NEAR ALLEY



Looking northbound on Fitzgerald Avenue

The purpose of the fence is to prevent patrons from entering into the residential areas during peak business hours.

PERMIT PARKING IN FRONT OF DRIVEWAY

