

January 31, 2007

Mr. Bob Zarilli  
Community Development Commission for the  
City of Commerce  
2335 Commerce Way  
Commerce, California 90040

**SUBJECT: ADDENDUM TO WORKPLAN FOR ADDITIONAL SITE  
CHARACTERIZATION**

**SITE: 5710 SMITHWAY  
COMMERCE, CALIFORNIA**

Dear Mr. Zarilli:

Block Environmental submitted a Workplan for Additional Site Characterization dated September 6, 2006 to the California Department of Toxic Substances Control (DTSC). They have reviewed the workplan and we concur with the changes requested as follows:

1. Move proposed background metals sampling points to an offsite location. We propose to collect these samples at the Rosewood Park located adjacent to the Commission's office. See attached map.
2. Collect soil vapor samples at a depth of 25 feet rather than 5 and 15 feet depths to target a sand interval more conducive for evaluating the presence of volatile organic compounds (VOCs) in soil vapor. Soil vapor sampling will follow DTSC/RWQCB guidelines (Advisory –Active Soil Gas Investigations, January 28, 2003).
3. If proposed monitoring wells UGW-11 and UGW-12 are moved due to utility conflicts or other reasons, we will notify DTSC of such changes in advance for their approval.
4. An additional well is proposed upgradient of UGW-10 to further evaluate potential offsite sources of VOCs and hexavalent chromium. We propose to install this well on the north end of the Ernst Paper Products facility located at 5745 Smithway. We understand that this property is still owned by the Commission which will facilitate access more readily. See attached site plan.
5. California Department of Water Resources guidelines for time elapses between installation and development, and development and sampling will be followed for the proposed new monitoring wells.

Please call if you have questions or require additional information.

Sincerely,

BLOCK ENVIRONMENTAL

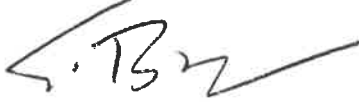

Erik M. Block, PG, REA  
President



Attachments:

- Figure 1: Map showing proposed background sampling location for metals  
Figure 2: Map showing proposed additional groundwater monitoring wells.

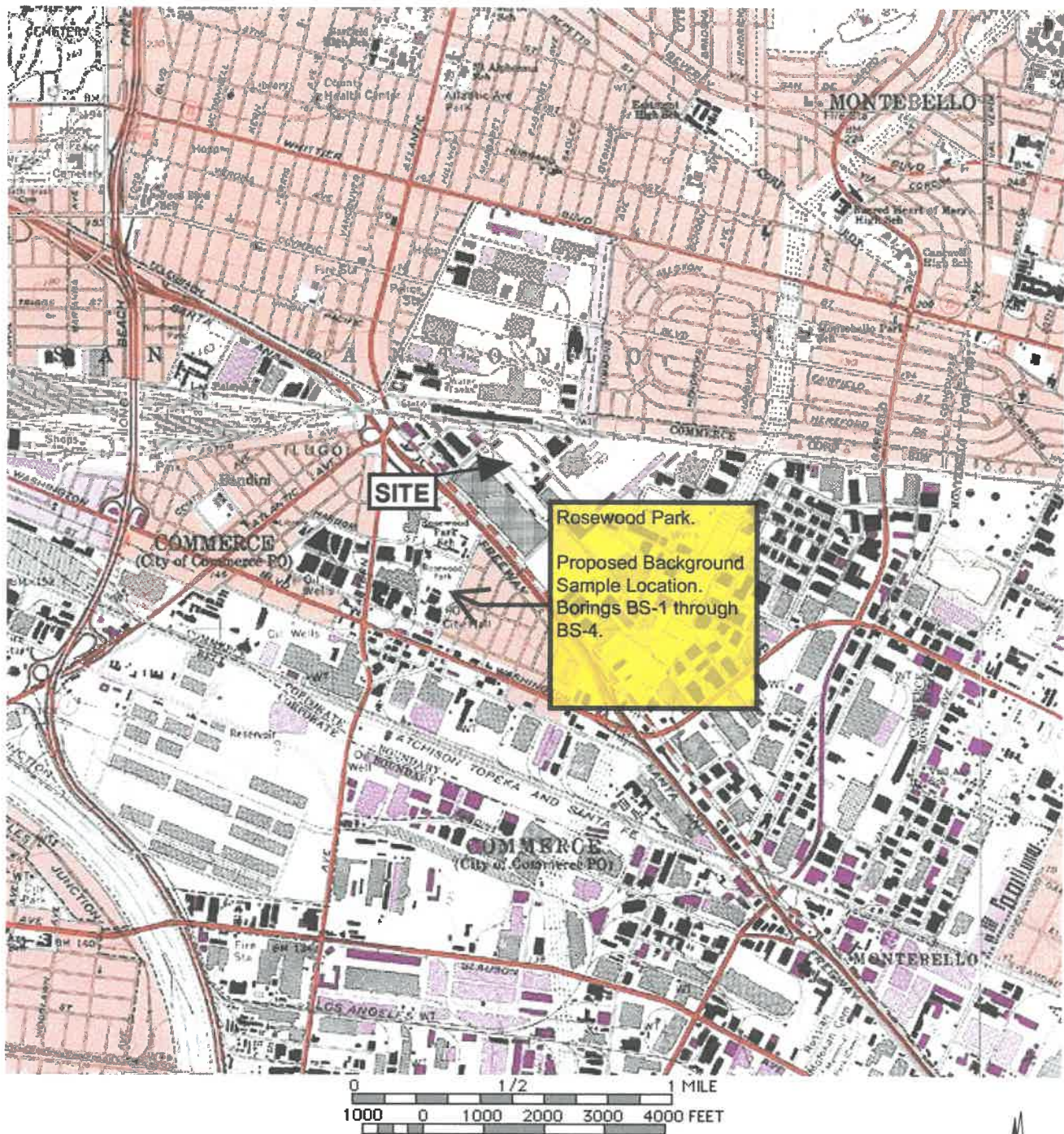

Printed from TOPO! ©1997 Wildflower Productions (www.topo.com)



5710 Smithway Street  
Commerce, California

INDEX MAP

FIGURE  
1

**BLOCK  
ENVIRONMENTAL**  
23265 South Pointe Drive, Suite 100  
Laguna Hills, California 92653



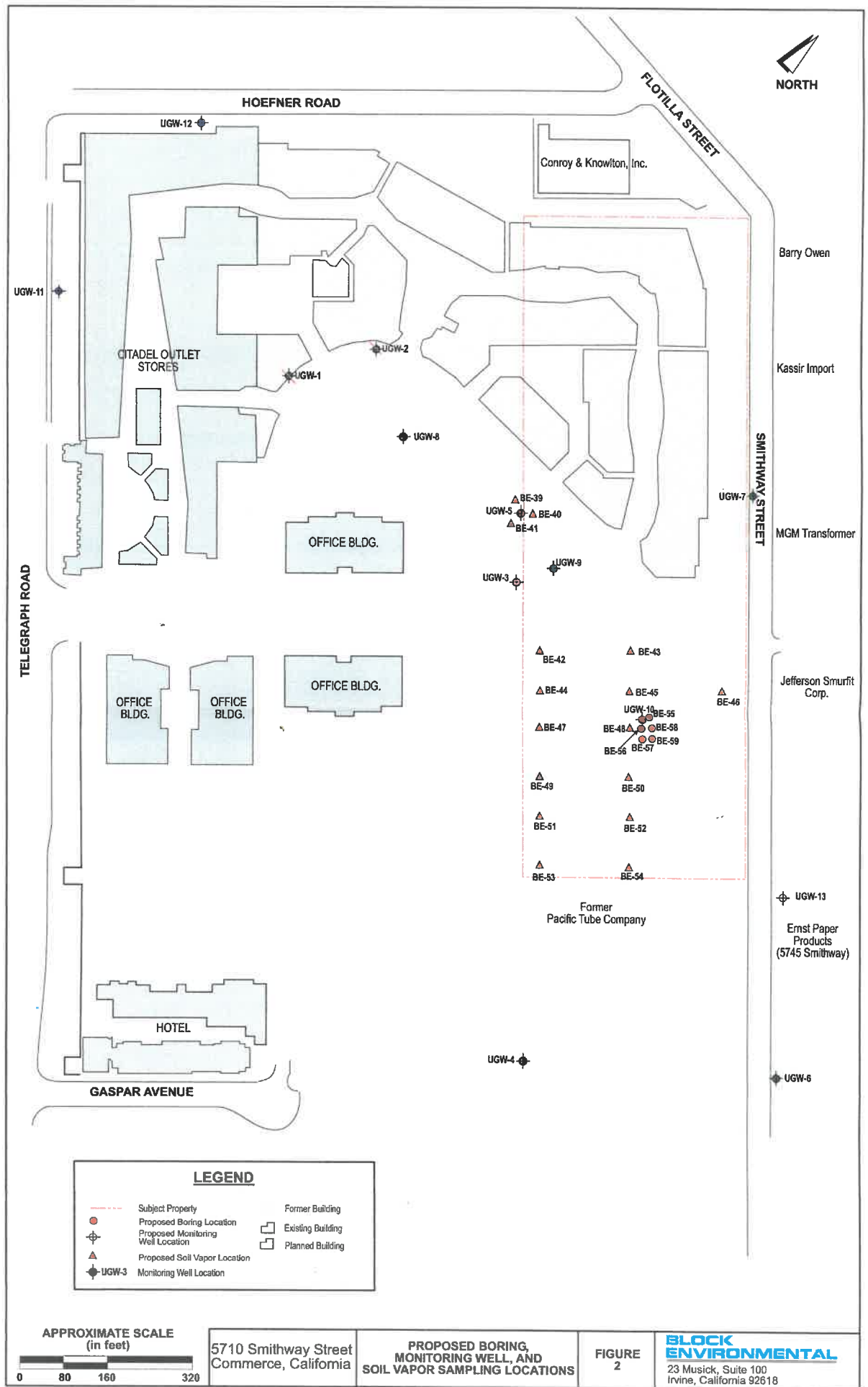

**SCHEDULE FOR  
ADDITIONAL SITE CHARACTERIZATION**  
5710 Smithway Street  
Commerce, California

| DESCRIPTION OF WORK  | SCHEDULE FROM<br>RELEASE TO PROCEED  |
|--|--|
| Preliminary Field Work   |  |
| <ul style="list-style-type: none"> <li>Update Site Safety Plan</li> <li>Negotiate Offsite Access</li> <li>Obtain Well Permits</li> </ul>   | 3 weeks  |
| Field Work   |  |
| <ul style="list-style-type: none"> <li>Drilling with Hollow-Stem Auger Equipment <p>Drill (4) soil borings (BE-56 through BE-59) near at the former Building 1 and 2 locations, where PCBs were stored, and at the MPS to a maximum depth of 40 feet. Soil samples to be collected and analyzed for PCBs.</p> <p>Drill one (1) soil boring (BE-55) near monitoring well UGW-10 to a maximum depth of approximately 95. Soil samples to be collected and analyzed for metals.</p> <p>Drill two (2) new groundwater monitoring wells (UGW-11 and UGW-12) near the west corner of the Citadel property near the intersection of Telegraph Road and Hoefner Road and one new groundwater monitoring well (UGW-13) upgradient of well UGW-10. The purpose of these wells is to further evaluate the extent of the dissolved-phase VOC and chromium plumes.</p> <p>Develop, survey and sampling monitoring wells (sampling to be incorporated into quarterly event).</p> </li> </ul> | <p>Outstanding</p> <p>Outstanding</p> <p>Completed</p> <p>Outstanding</p> <p>2 weeks</p> |
| <ul style="list-style-type: none"> <li>Drilling Work with Direct Push Equipment <p>Conduct soil vapor sampling on the southeastern half on the property to evaluate the possible presence of VOC contamination. Twelve (12) soil vapor borings (BE-42 through BE-54), will be advanced and soil vapor samples will be collected at a depth of approximately 25 feet.</p> <p>Drill a minimum of four (4) offsite locations (BS-1 through BS-4) will be sampled at depths of 1 and 5 feet to obtain additional background metal concentrations at Rosewood Park.</p> <p>Soil vapor sampling will be performed near Monitoring Well UGW-5 to evaluate if potential VOCs are present in the vadose zone. Three borings (BE-39 through BE-41) will be advanced and soil vapor samples will be collected at 5 and 15 feet.</p> </li> </ul>   | <p>Completed</p> <p>Outstanding</p> <p>Completed</p> <p>1 week</p>                       |

| DESCRIPTION OF WORK (continued)   | SCHEDULE FROM<br>RELEASE TO PROCEED |
|---|-------------------------------------|
| Laboratory Analytical   |                                     |
| <ul style="list-style-type: none"> <li>Laboratory Analysis of Samples</li> </ul>  | 2 weeks                             |
| Data Analysis and Report Preparation  |                                     |
| <ul style="list-style-type: none"> <li>A report will be prepared based on the results of the field activities and laboratory analysis performed during this investigation. The report will include the results of laboratory analysis of the soil, soil vapor, and groundwater water samples, borings logs, interpretive maps, and findings and conclusions.</li> </ul> | 4 weeks                             |
| <b>TOTAL:</b>   | <b>11 weeks</b>                     |

This schedule is based on our best estimate at this time for each event.